

## A Easy Set up Components

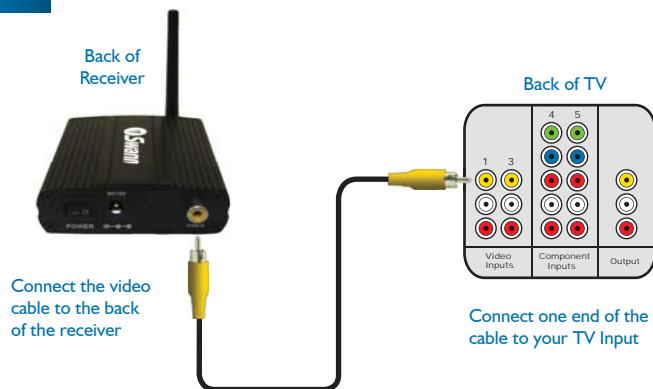

## C Connecting the receiver to your TV



## B Connecting the receiver to record on a VCR

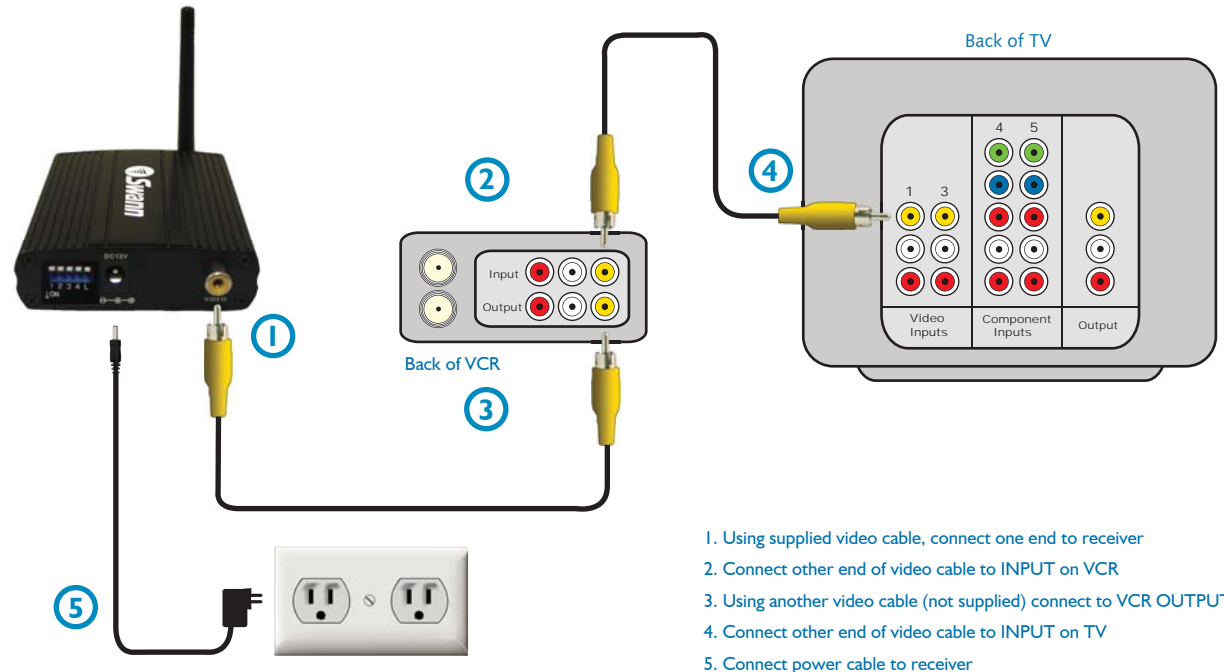

## D Viewing the camera and recording to VCR

1. Power on the receiver, VCR and TV
2. Using your **TV's** remote control tune your TV to the correct **INPUT\***. In our example above the TV should be set to **INPUT 1**
3. Using your **VCR's** remote control tune your VCR to the **LINE 1 INPUT\***
4. You should now see your cameras on the TV screen. Follow your manufacturer's instructions to record to your VCR

\*Some VCR's and TV's will list this as INPUT, A/V, SOURCE, L1, Channel 0 - Consult your manufacturer's manual for more information

## E Setting up Wireless or Wired options

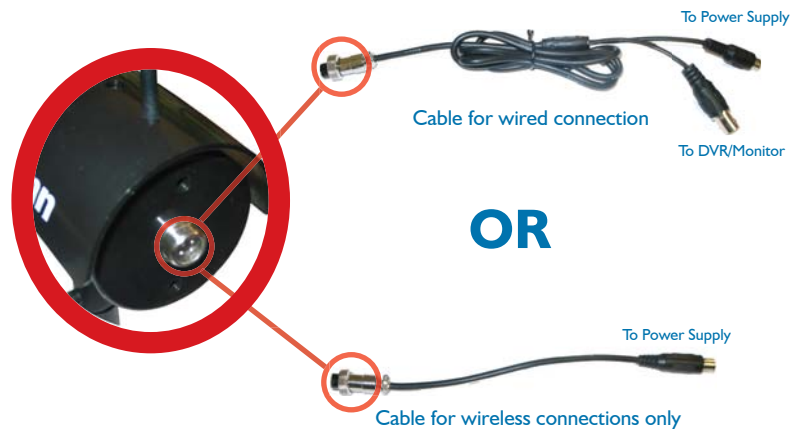

## F Wireless Camera Positioning

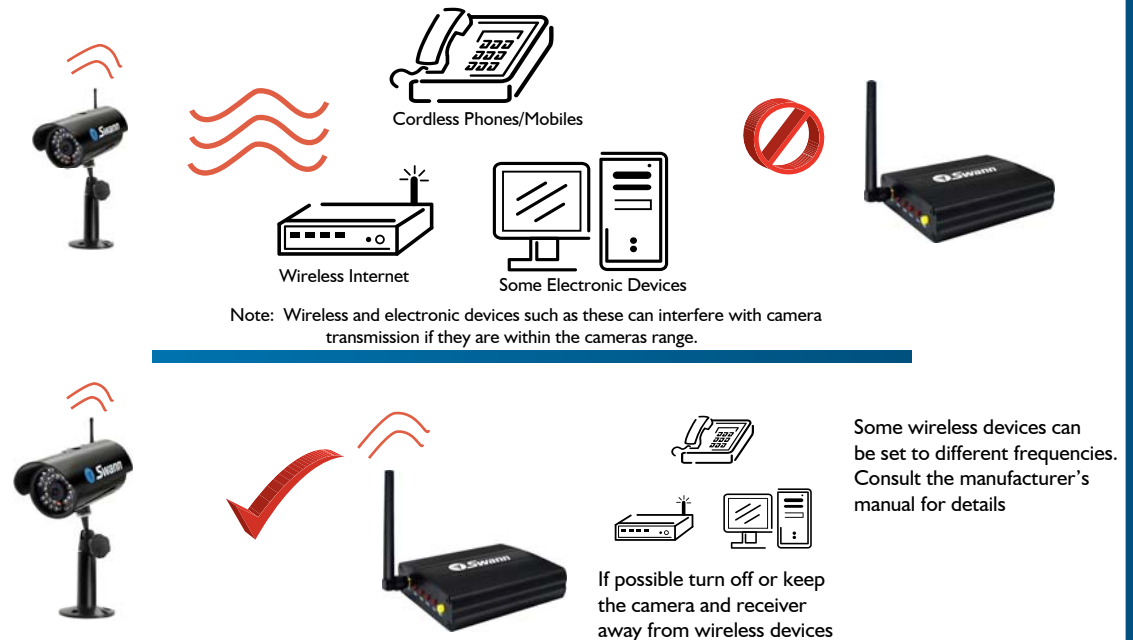

## G Achieving the highest quality wireless signal

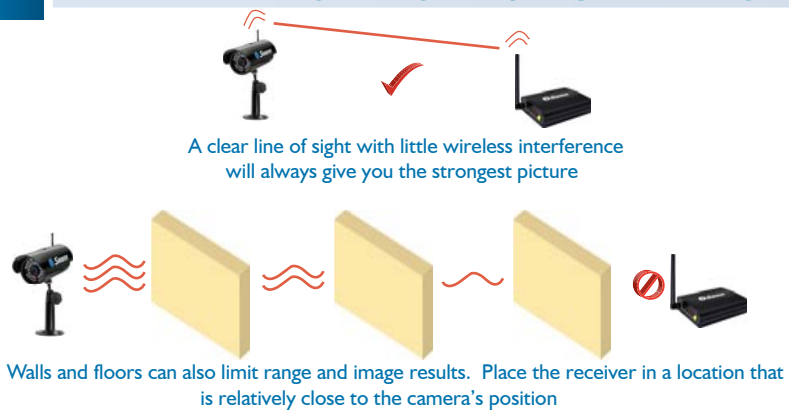

## H General Installation Notes and Tips

1. Test the camera signal before permanently installing the cameras.
2. Using battery power is only recommended for testing purposes as the cameras do require constant power to operate.
3. IR or night vision will reflect off of glass or windows and overexpose the picture. Try placing cameras in direct line of sight of your subject.
4. Never aim the camera directly at the sun as this can permanently damage the lens.
5. Never submerge the camera in water. Some shelter is recommended such as an awning or eave.